

R9/R12 SERIES

ROUND VANDAL RESISTANT
CEILING/WALL MOUNT UNITS

Cat. #		Approvals
Job	Type	



APPLICATIONS

- Use for ceiling/wall perimeter or entry at mounting heights of 8-15 feet.

SPECIFICATIONS

- Polycarbonate diffusers with stainless steel center-pin torx tamper-proof hardware.
- H.I.D. units have spun aluminum ballast enclosures with 1/2" knockouts.
- H.I.D. units are medium base and are complete with lamp.
- Fluorescent units are electronic with PLT lamps included.
- Fluorescent units are low profile, no ballast box or conduit hubs.
- All units are Quad-Tap®. Fluorescent units are 50/60 Hz standard.
- H.I.D. units have dark bronze protective paint finish.

LISTINGS

- All units UL listed to 1598 for use in wet locations.



R9 H.I.D.



R12 H.I.D.



R9 42F



R12 84F

H.I.D.

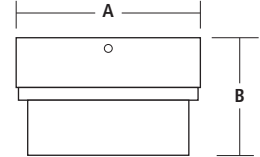
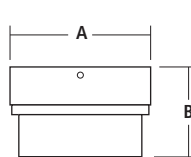

CFL

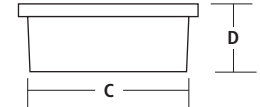
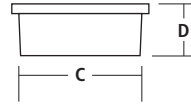

	A	B	C	D
R9	11.4" 290 mm	7.4" 189 mm	9.8" 249 mm	4.25" 108 mm
R12	15" 380 mm	7.9" 200 mm	12.8" 325 mm	4.9" 124 mm

ORDERING INFORMATION

Catalog Number	Description	Voltage ¹	Weight	
			lbs	(kg)
11 INCH DIAMETER				
R9-42F	42W Fluorescent	Quad-Tap®	5	(2.3)
R9-70H	70W Pulse Start	Quad-Tap®	10	(4.5)
R9-70S	70W High Pressure Sodium	Quad-Tap®	10	(4.5)
15 INCH DIAMETER				
R12-84F	2X42W Fluorescent	Quad-Tap®	10	(4.5)
R12-100H	100W Pulse Start	Quad-Tap®	15	(6.8)
R12-150P	150W Pulse Start	Quad-Tap®	16	(7.3)
R12-150S	150W High Pressure Sodium	Quad-Tap®	16	(7.3)

¹ Quad-Tap® - 120,208,240,277V

REPLACEMENT PARTS

(order as separate part #, field installed)

Catalog Number	Description
SM020LENS	Replacement Lens only for R9 units
SM021LENS	Replacement Lens only for R12 units

Due to our continued efforts to improve our products, product specifications are subject to change without notice.



Outdoor Lighting

Hubbell Industrial Lighting • 701 Millennium Boulevard • Greenville, SC 29607 • PHONE: 864-678-1000

For more information visit our web site: www.hubbell-ltg.com